

GRS[®] BenchMate™ QCX

INSTRUCTIONS • #004-831 and #004-832

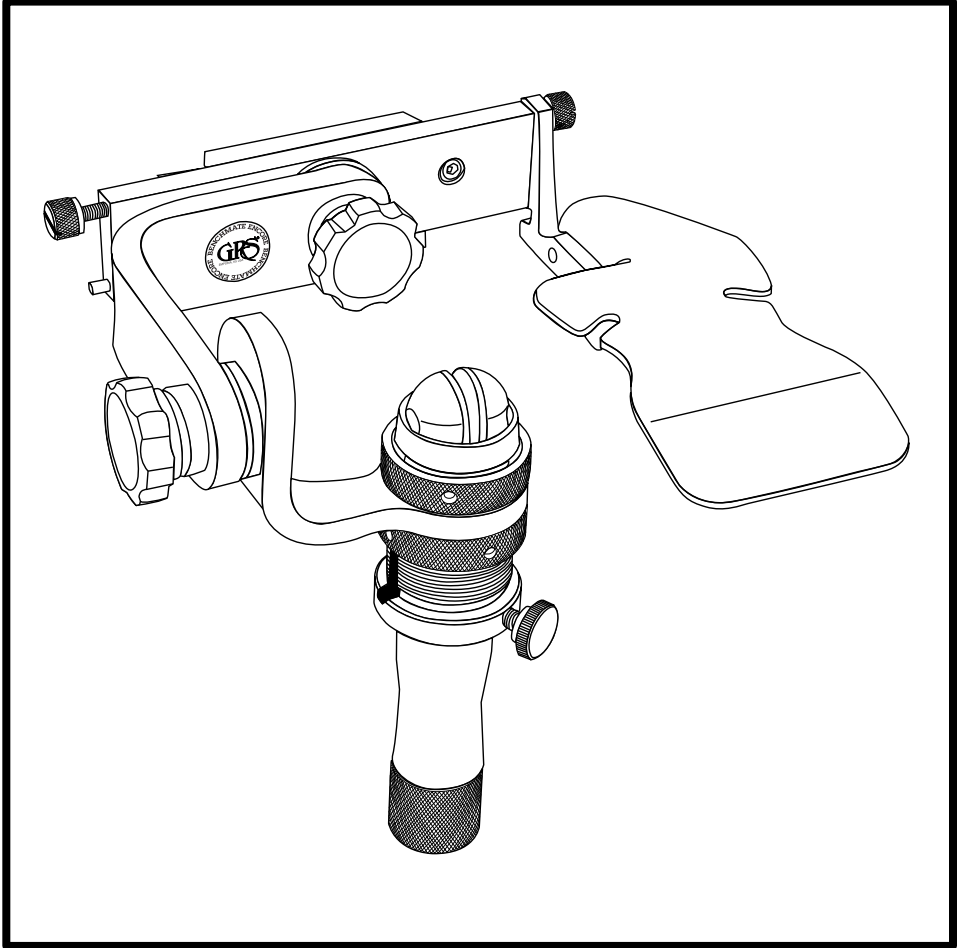

CONTENTS

1. INSTALLATION	2
2. HEIGHT ADJUSTMENTS	3
3. CHANGING QC FIXTURES	4
4. INSTALLATION OF THE HANDREST.....	4
5. INSTALLATION OF THE THIRD-HAND ATTACHMENT	5
6. MAINTENANCE	5
PARTS LIST • #004-831 AND #004-832	6
PARTS LIST • #004-832	8

1. INSTALLATION

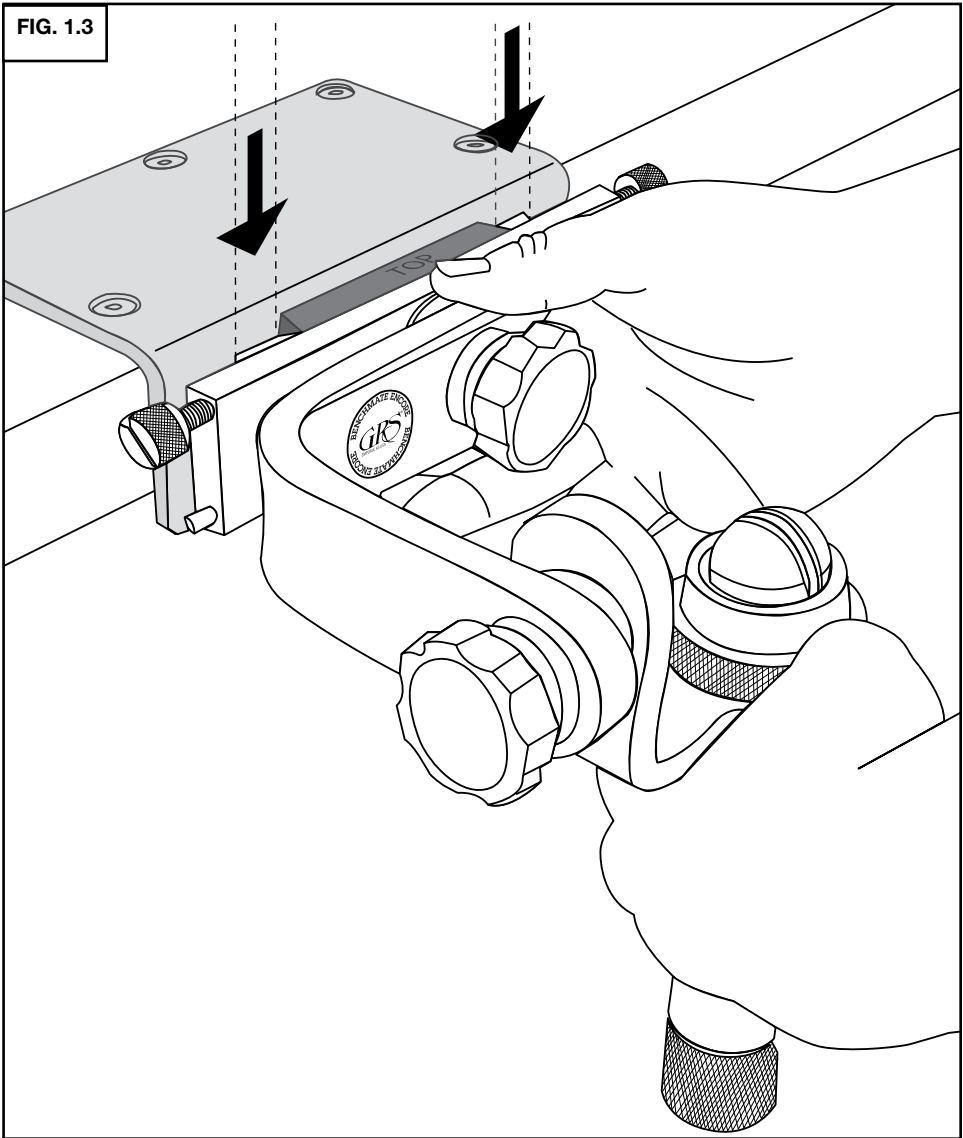
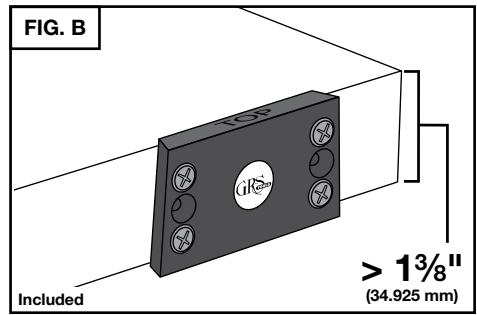
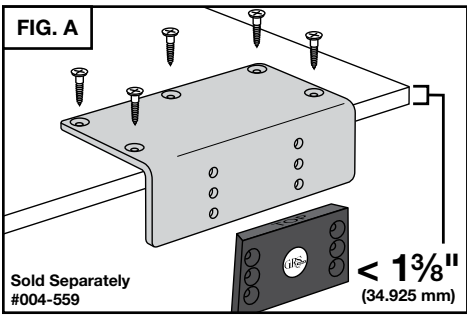

2. HEIGHT ADJUSTMENTS

MANDREL HEIGHT

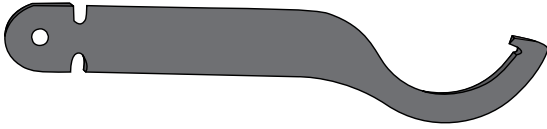

Spanner Wrench

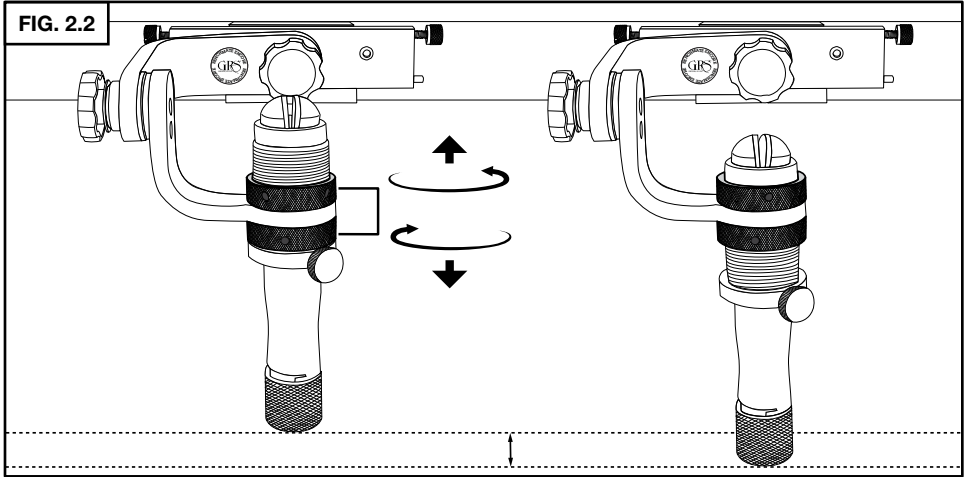
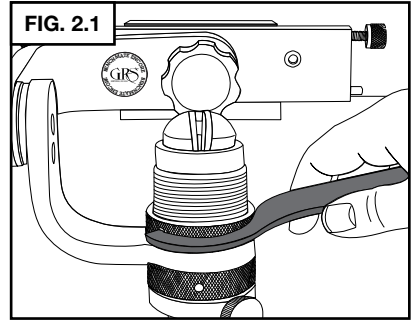

ARM HEIGHT

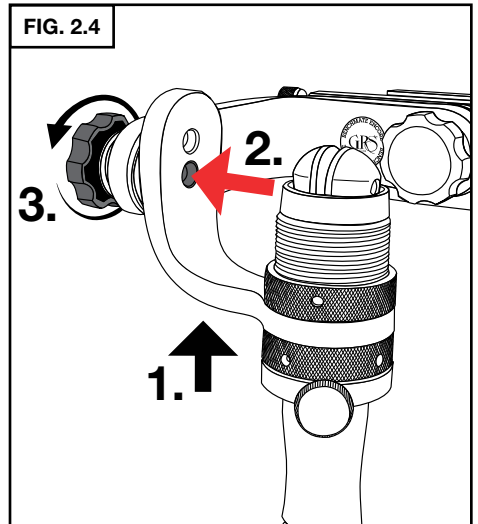
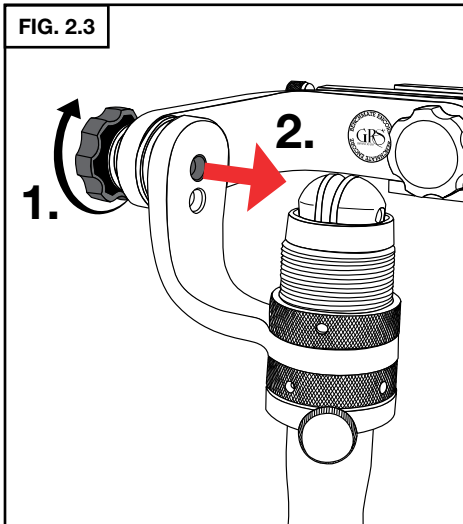

3. CHANGING QC FIXTURES

FIXTURE REMOVAL

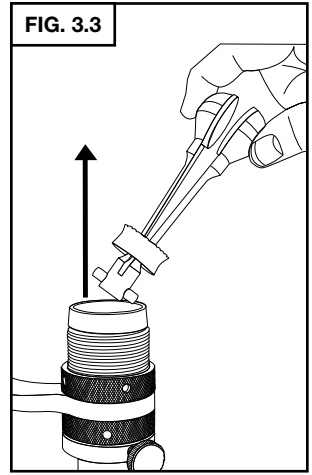
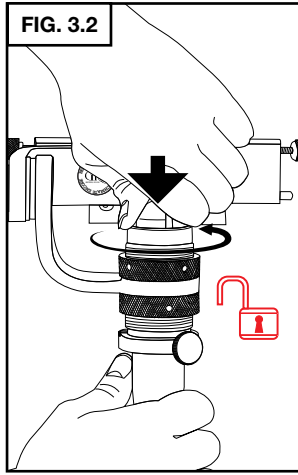
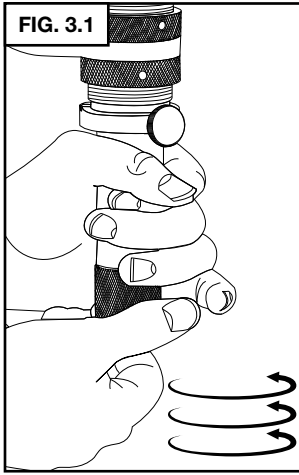

FIXTURE INSTALLATION

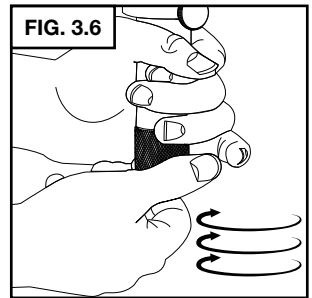
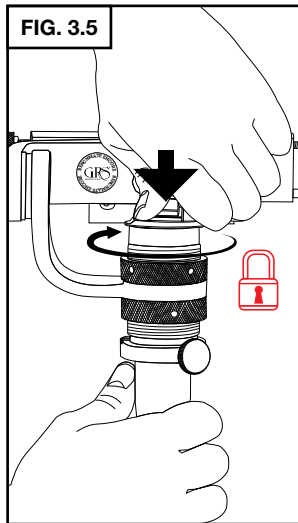
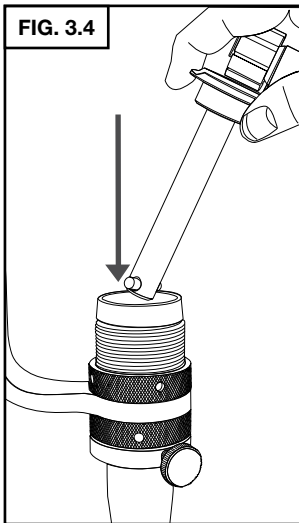

WARNING

Make sure QuickChange fixture is seated fully before tightening with mandrel knob. A fixture can be ejected with force if not properly seated when tightening.

4. INSTALLATION OF THE HANDREST

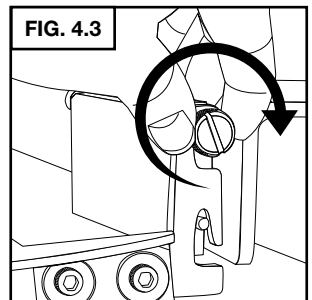
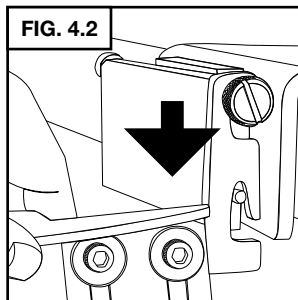
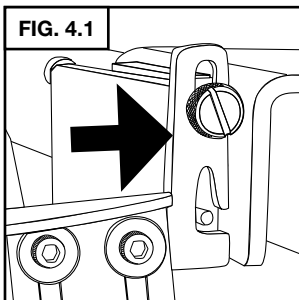

5. INSTALLATION OF THE THIRD-HAND ATTACHMENT

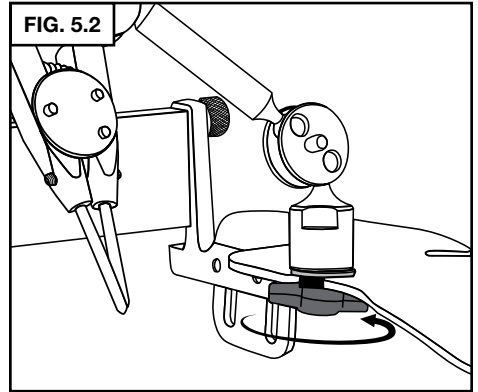
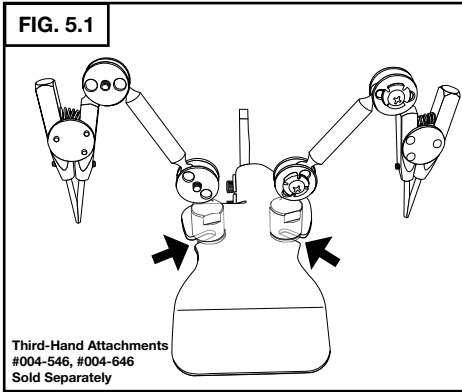

6. MAINTENANCE

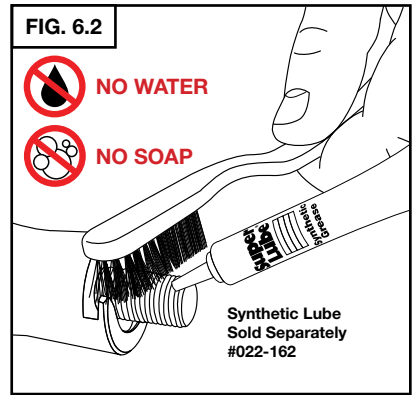
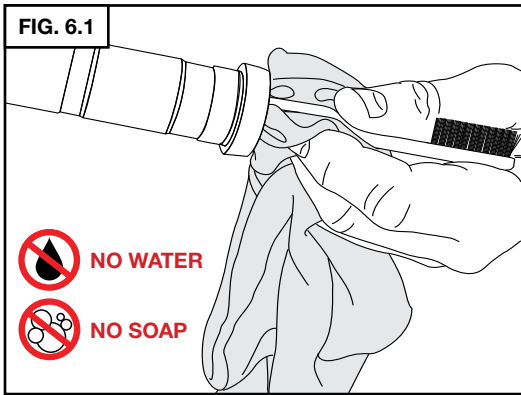

FOAM SEAL



Replacement #004-126

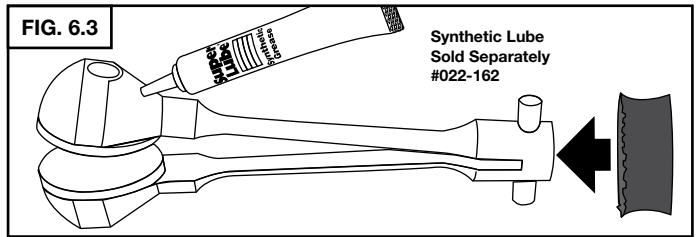

PLASTIC INSERTS

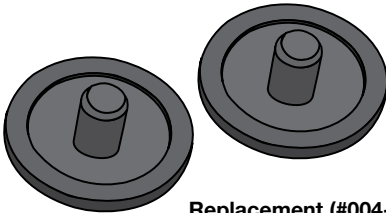

Replacement (#004-090 or
#004-558 pkg. of 10)

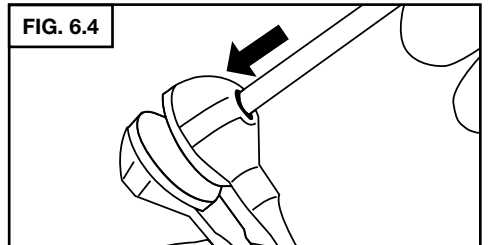

GRS[®] BenchMate™ QCX

PARTS LIST • #004-831 and #004-832

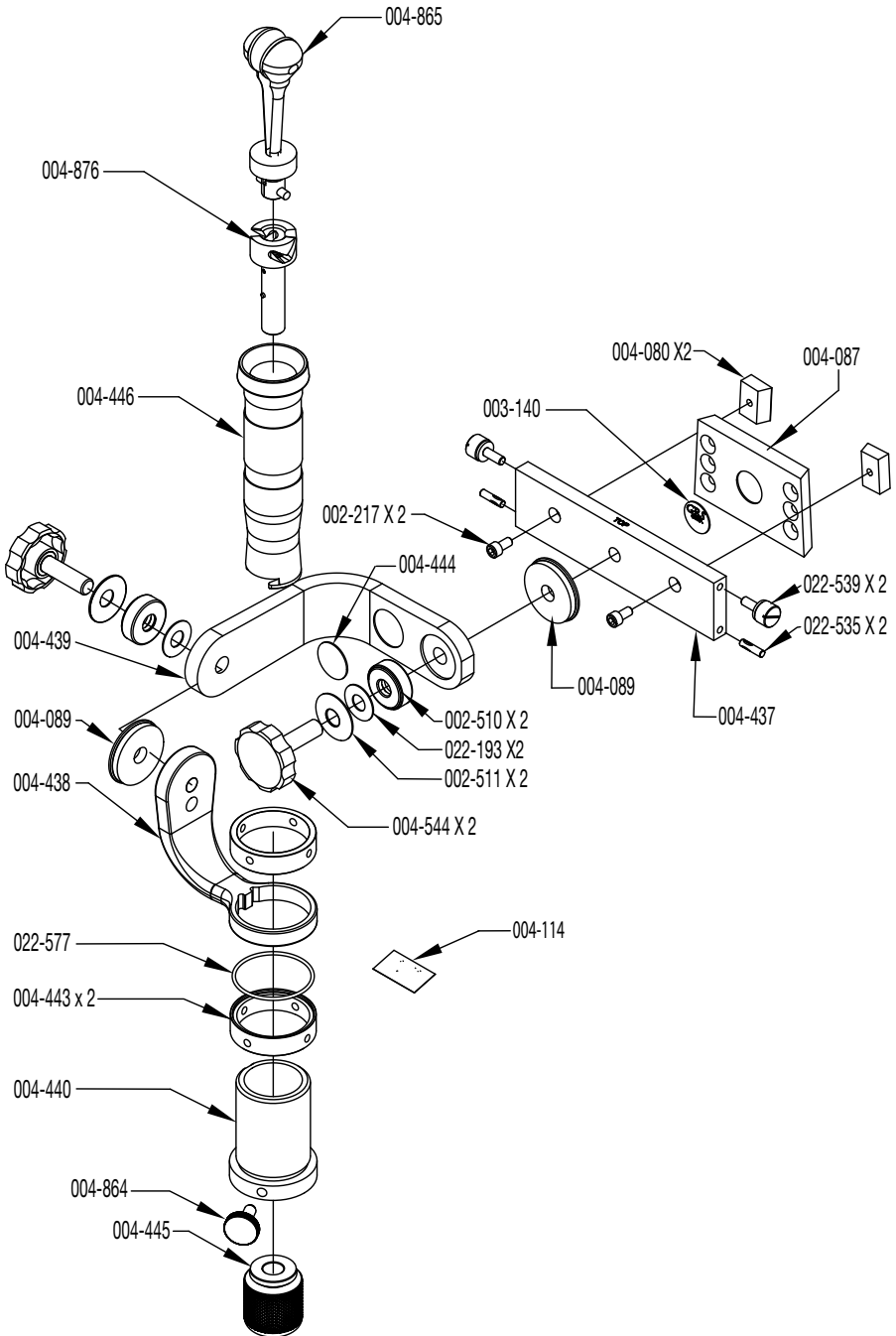

PART NO.	DESCRIPTION	QTY
002-217	#10-32 X 3/8 SHCS BLK	4
002-247	WASHER .191 X .628 X 16 GA	2
002-510	BEARING, THRUST	2
002-511	SPRING, DISC	2
003-140	LABEL, GRS	1
004-080	BEVELED RETAINING BLOCK	2
004-087	MOUNTING PLATE (BEVELED)	1
004-089	WASHER, FLAT FRICTION	2
004-114	LABEL, BENCHMATE	1
004-437	MOUNTING PLATE	1
004-438	LOWER ARM FOR MICROSCOPE CENTERING BENCH MATE FRAME	1
004-439	UPPER ARM	1
004-440	THREADED COLLAR	1
004-441	HAND REST MOUNT (MACHINED)	1
004-442	HAND REST	1
004-443	KNURLED LOCK RING	2
004-444	(NEW) BENCHMATE I.D. DECAL	1
004-445	CLAMP KNOB	1
004-446	CLAMP TUBE	1
004-544	KNOB ASSY 3/8-24	2
004-734	ACCESSORY PACK ENCORE 2 AXIS	1
004-864	NYLON TIPPED THUMB SCREW ASSY	1
004-865	COMPLETE QUICK CHANGE JAW ASSEMBLY	1
004-876	ENCORE QC TOOL RECEIVER SUB ASSEMBLY	1
022-193	WASHER	2
022-535	DRIV-LOC PIN .156 X .625 TYPE H	2
022-539	THUMB SCREW	2
022-577	O-RING 1 5/8 X 1 3/4 X 1/16	1

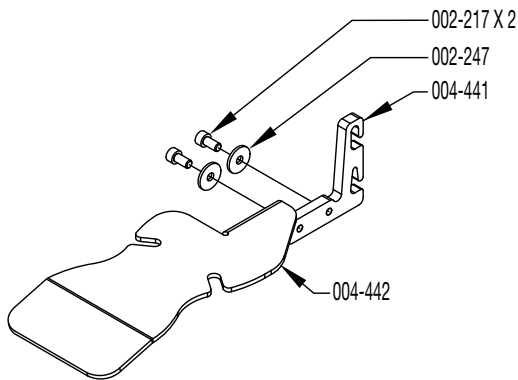
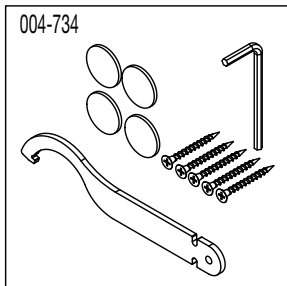

GRS[®] BenchMate™ QCX

PARTS LIST • #004-832

004-831

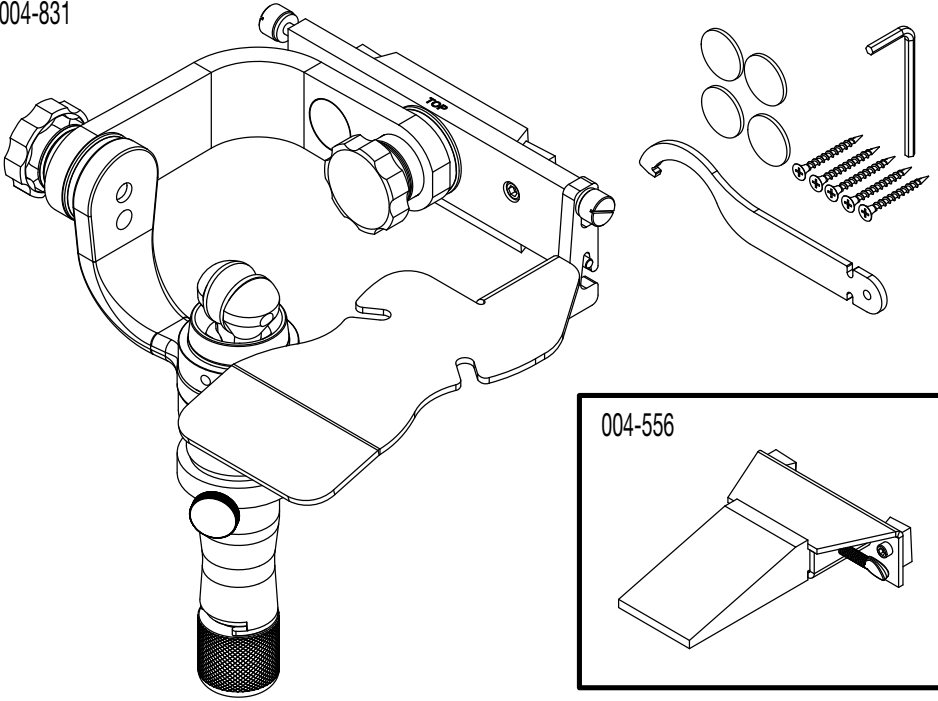

004-877

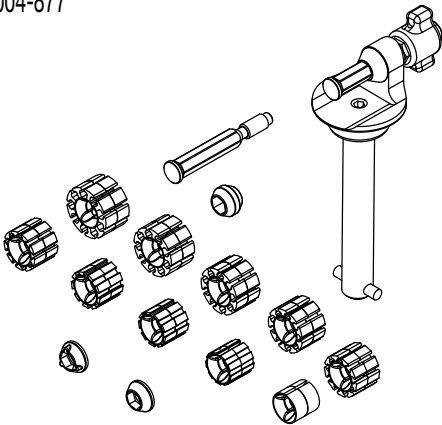

004-878

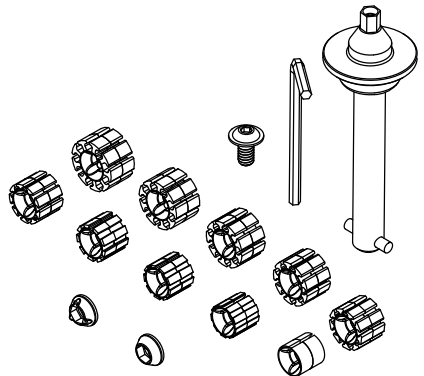

GLEND O LLC

900 Overlander Road • Emporia, KS 66801 USA
800-835-3519 • 620-343-1084 • Fax: 620-343-9640
grs@grstools.com • www.grstools.com
Last Update: 2015-12-04